

ABINGTON

Noncombustible Fireplace Mantel

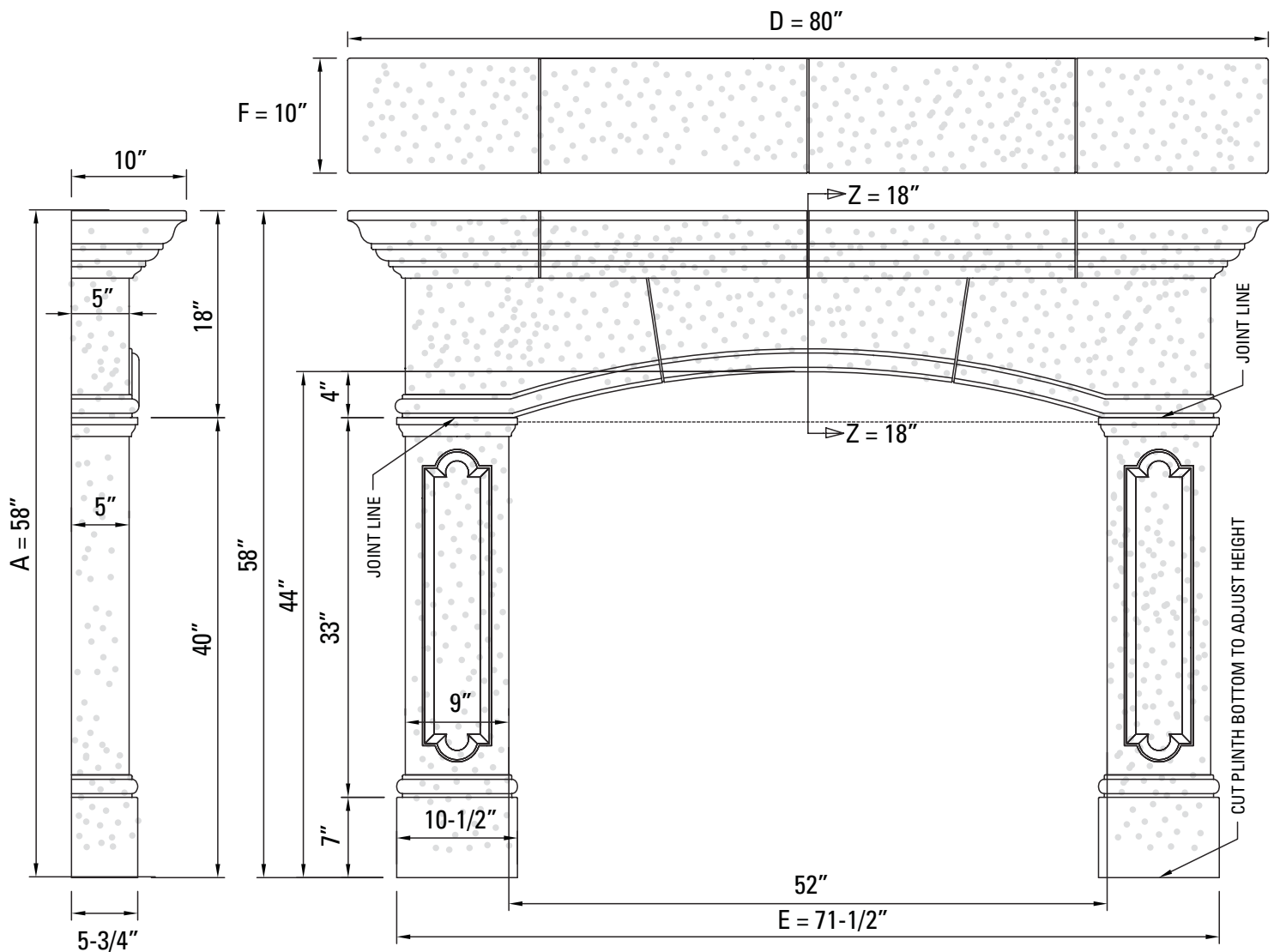

FEATURES & SPECIFICATIONS

- High Definition, crisp details
- Adjustable height
- Fast, easy installation
- Material is sealed from the factory and requires no further finishing
- Supplied in 3 pieces

Approximate Weights:

Complete mantel:	180 lbs.
Mantel Top:	120 lbs.
Each mantle leg:	30 lbs.
Crated Weight:	240 lbs.

- Marble, stone, or other noncombustible filler panel material (not supplied with mantle) combined with adhesive must accommodate 1" cavity at mantle legs to support the bearing surface of the inside edges of the mantle shelf and legs against the wall on the fire box side, and to cover the wall area between the firebox opening and mantle components. At least 1" of the surround filler panel should extend behind the inside edges of the mantle for support. Cast stone filler panels and 3 pc. hearth are included as part of the complete Thin Cast Stone mantel kit.

